

Exclusive Charter



Prairie Public presents

Normandy, Paris & the Seine River Cruise

featuring 7 nights aboard the Amadeus Diamond

10 Days April 5, 2027



**BOOKING
DISCOUNT!**

Save \$200 per person
\$400 per couple*

*See Reservation Info for
Booking Discount details



Etretat

10 Days April 5, 2027

Normandy, Paris & the Seine River Cruise

Day 1 - DEPART US - OVERNIGHT FLIGHT

Day 2 - ARRIVE PARIS - Enjoy Paris day at leisure

Day 3 - PARIS

Meet your PWD Tour Manager - Transfer to your ship

Board the **MS Amadeus Diamond** for your **7 Night Seine River Cruise**

Welcome Drink & Welcome Dinner onboard - Ship departs Paris

⊗ (B & D)

Overnight - Amadeus Diamond

Day 4 - CONFLANS

Morning - Cruising - Arrive in Conflans

Afternoon - **Auvers-sur-Oise Excursion** (Village of Van Gogh)

⊗ (B,L,S & D)

Overnight - Amadeus Diamond

Day 5 - ROUEN

Morning - **Rouen Walking Tour** (Museum Town)

Afternoon - Explore Rouen on your own - Ship departs late afternoon

⊗ (B,L,S & D)

Overnight - Amadeus Diamond

Day 6 - LE HAVRE

Morning at Leisure or *Optional Excursion to Honfleur*

Afternoon - **Étretat Tour** (Walk the Normandy Coastline & scenic village)

⊗ (B,L,S & D)

Overnight - Amadeus Diamond

Day 7 - LE HAVRE - CAUDEBEC-EN-CAUX

Full Day Tour of Historic Normandy with Lunch - WWII D-Day Landing Beaches incl. Omaha Beach, American Cemetery Colleville & WWII Museum

⊗ (B,L,S & D)

Overnight - Amadeus Diamond

Day 8 - LES ANDELYS - ONBOARD CRUISING ALL DAY

Morning - Cruising or *Optional Excursion to Monet's House & Garden*

Afternoon - Relax & Seine River Cruising

Gala Farewell Dinner Onboard

⊗ (B,L,S & D)

Overnight - Amadeus Diamond

Day 9 - PARIS

Morning - **Paris City Tour** - Afternoon at Leisure in Paris to explore

Optional Excursion - Montmartre Walking Tour

Final Dinner Onboard in Paris - Ship Docked overnight in Paris

⊗ (B,L,S & D)

Overnight - Amadeus Diamond

Day 10 - PARIS - FLIGHT HOME

Transfer to Paris Airport - Fly Home or *2 Night London Extension*

⊗ (B)

B-Breakfast Onboard • S-Snacks Onboard afternoon and/or evening

CITIES & PORTS

PARIS

Paris, the "City of Light" is the world's most visited capital. Enjoy a Paris City Tour to see the beloved landmarks that line the Seine including the Notre Dame Cathedral, the Louvre and the Eiffel Tower. Also see the majestic Arc de Triomphe and ride along the Champs-Élysées. During your leisure afternoon maybe wander the historic banks of the Seine which are a UNESCO World Heritage Site.

CONFLANS - AUVERS-SUR-OISE

Visit the village of Auvers-sur-Oise, an inspiration to many of the famous Impressionist masters including Cezanne, Pissarro & Daubigny. The most famous of these artists is Vincent van Gogh. See Auberge Ravoux, where Van Gogh lived. See his final resting place & where he was inspired to create nearly 80 canvases. Experience a multimedia museum journey about the great masters at the Chateau D'Auvers Museum featuring over 500 paintings with sound effects & period music.

ROUEN

Enjoy a Rouen Walking Tour including a visit to the magnificent cathedral that inspired Claude Monet, and the modern Church of Joan of Arc with its wonderful 16th-century stained-glass windows. Rouen is known as Museum Town for its many museums, was important in the Roman era and Middle Ages, and features a cobblestoned pedestrian center with medieval half-timbered houses.

LE HAVRE - ETRETAT

A UNESCO World Heritage Site & important port, Le Havre, sits where the Seine River meets the English Channel. The harbor was destroyed in World War II and was rebuilt. Enjoy a Etretat Tour to explore attractive seaside village and the famous Normandy coastline featuring cliff-top paths for views of steep chalk rocks with impressive needlelike formations, which have inspired many well-known artists. An optional will be available to the beautiful harbor city of Honfleur.

HISTORIC NORMANDY TOUR

Discover Normandy on this full day tour featuring many historic landmarks. Visit Pointe du Hoc, site of a German artillery unit where the US Army climbed 100 foot cliffs. Stop at Omaha Beach, the most famous of the five code named beaches. Visit Colleville Sur Mer, an American Cemetery where over 9,000 American troops are laid to rest. Enjoy lunch before a visit to a World War II Museum to learn more about the landings, battles and liberation of this region.

LES ANDELYS - SEINE CRUISING

This morning stop in the little town of Les Andelys in the shadow of Chateau Gaillard, one time home to Richard the Lionheart. An amazing optional will be available to visit nearby Giverny, home to Impressionist Claude Monet, where you see Monet's House & wander his Garden. The optional makes a photo stop at Chateau Gaillard. After a long day to Normandy, today is the perfect day to relax onboard for a half or full day & enjoy the passing Seine scenery and ship amenities.

Optional 2-Night London Post Cruise Extension

\$1199 pp dbl +\$500 single supplement

DAY 10 - PARIS - EUROSTAR TRAIN - LONDON SIGHTSEEING

Board the **Eurostar Train** in Paris for the 2.5 hour rail experience to London.

Enjoy a **London City Tour** to see Kensington Palace, the Tower of London, Trafalgar Square, the Houses of Parliament, Big Ben & Buckingham Palace.

⊗ (B-onboard ship)

Overnight - London

DAY 11 - LONDON - DAY AT LEISURE

Explore London at your own pace.

⊗ (B)

Overnight - London

DAY 12 - LONDON - TRANSFER TO AIRPORT - FLIGHT HOME ⊗ (B)

London Optional Extension Includes: 2-Nights Hotel Accommodations - London, Eurostar Train from Paris to London, London City Tour, 2 Meals (2-B), Tour Manager & Transfers to London Heathrow Airport.

Notes: London Extension must be booked at time of deposit. Passengers must wheel own luggage onto train. Due to group air policies outbound air could be different schedule than the group for London extension passengers. Based on 20 passenger minimum.



MS AMADEUS DIAMOND DECK PLAN

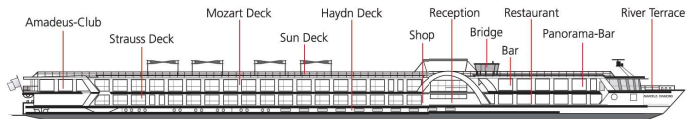

SUN DECK

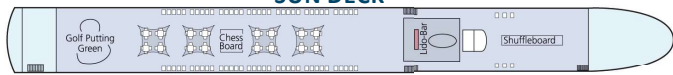

MOZART DECK

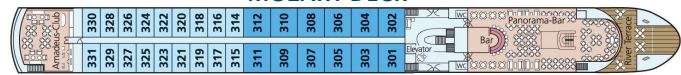

STRAUSS DECK

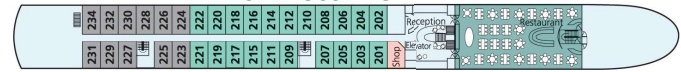

HAYDN DECK

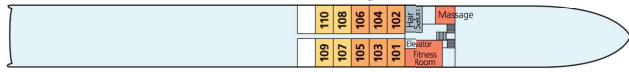

THE SHIP - MS AMADEUS DIAMOND

The 144-passenger *MS Amadeus Diamond* has been a highlight of the fleet since 2009, and is the jewel of the French waterways after its complete renovation in 2019. The ship is now scheduled for another refurbishment prior to the 2027 season, which will include staterooms, bathrooms and other onboard facilities. The Diamond travels exclusively along the Seine and allows guests to experience the charm of northern France in an unforgettable way. The Restaurant and the Panorama Bar offer divine views of the passing riverscapes. The 60-staterooms & 12-suites are bright & modern. The attentive English Speaking onboard service staff will see to your comfort with typical European hospitality. The beauty of river cruising is that the most interesting destinations come to you. This Diamond charter features English-only onboard commentary with inclusive sightseeing excursions balanced with choice to simply relax onboard during your leisure time or add sightseeing with optional excursions. The ship offers countless choices for your leisure time including a putting green, fitness studio, massage facilities & quiet spaces to escape with a book.

ALL MEALS INCLUDED ONBOARD

Three meals daily are served in the exquisite restaurant and feature local & international specialties. All dinners are four courses. Lunch & Dinners are served with included Hand Selected Wines, Beer & Soft drinks. While dining, you have splendid views of the passing scenic landscapes through the large picture windows. Enjoy afternoon and/or late evening snacks in the lounge based on the daily schedule.

COMFORTABLE & MODERN STATEROOMS

After boarding, unpack once. All staterooms onboard offer excellent river views and are bright, modern and inviting giving you a space of your own with all the amenities and pleasant touches of an upscale hotel. The Mozart & Strauss Decks feature suites and staterooms with French Balconies. Staterooms on the Haydn Deck have a fixed window. Each stateroom is fully equipped with comfortable & modern furnishings including flat screen TV, individual heating/air conditioning controls, safe, phone, hair dryer and a private bathroom with shower.

SHIP TECHNICAL DATA

Refurbished/Built: 2027*/2019/2009 Decks/Crew members: 4/40
Length/Width (ft): 361/36.5 Cabins/Suites: 60/12

ACTIVITY LEVEL

Easy **1** **2** **3** **4** Active

*The Diamond is scheduled for stateroom & other onboard facilities refurbishments prior to the 2027 season.

Other Notes - Excursions require moderate walking with some stair climbing possible. -Hotel/Ship Check in time in Europe typically begins between 3-4 pm.

INCLUSIONS

- Roundtrip Airfare - FAR**
- 1 Pre-Night Hotel in Paris
- 7 Night Cruise - Outside Cabin
- 21 Meals (8-B, 6-L, 7-D)
- Hand Selected Wines, Beer & Soft drinks with Lunch & Dinners
- PWD Tour Manager
- Ship Staff
- Wi-Fi Onboard
- Welcome & Farewell Dinners
- Int'l Air Taxes/Fuel/Port Charges
- Baggage Handling at Ship
- Ship Transfers

** Other gateways available upon request

HIGHLIGHTS & EXCURSIONS

- 5 Included Excursions/Tours
- Paris City Tour
- Full Day Historic Normandy Tour - WWII D-Day Landing Beaches incl. Omaha, Colleville Cemetery and WWII Museum
- Painter's Village of Auvers-sur-Oise Tour & Chateau D'Auvers Museum
- Rouen Walking Tour
- Étretat Tour - Normandy Coast & Village
- Paris Extended Port Stay

RATES

Cat E - Haydn Deck	\$6699 pp dbl*	\$6499 pp dbl with BD**	+\$1920 single
Cat D - Haydn Deck	\$6999 pp dbl*	\$6799 pp dbl with BD**	+\$1920 single
Cat C - Strauss Deck	\$7599 pp dbl*	\$7399 pp dbl with BD**	+\$2320 single
Cat B - Strauss Deck	\$7799 pp dbl*	\$7599 pp dbl with BD**	+\$2320 single
Cat A - Mozart Deck	\$7999 pp dbl*	\$7799 pp dbl with BD**	+\$2720 single
Suite - Mozart Deck	\$8699 pp dbl*	\$8499 pp dbl with BD**	+\$3320 single

*Regular Rate or **Save \$200 per person/\$400 per couple with Booking Discount Rates (BD)

STATEROOMS & SUITES



STATEROOMS (162 Sq Ft)

Staterooms feature 2 twin beds that can be separated or put together, flat screen TV, hair dryer, private bath with shower, closet, phone, desk, chair & safe. Floor to ceiling sliding glass doors with French Balcony on Mozart & Strauss Decks. Fixed window on Haydn Deck.

(Stateroom size & amenities can vary)



SUITE - FRENCH BALCONY (237 Sq Ft)

Suites are on the Mozart Deck & feature floor to ceiling sliding glass doors with French Balcony, 2 twin beds that can be separated or put together, flat screen TV, hair dryer, private bath with shower & bathtub, phone, closet, desk, chair, safe, bathrobe & mini-bar.

(Suite size and amenities can vary)

Category E & D

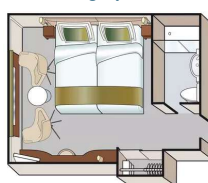

Category C, B & A

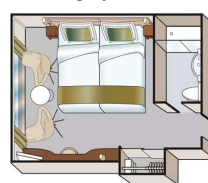

Suite



Reservation Form (River Cruise)

Normandy, Paris & Seine Cruise

April 5, 2027

Booking #220855 (Web Code)

Contact Information/Mail Reservation Form to:

Prairie Public • Attn: Troy Davis

207 North 5th Street

Fargo, ND 58102

701.239.7510 • tdavis@prairiepublic.org

Cabin Category Requested: *(All Cabin Categories are on a space available basis)*Cat E: Cat D: Cat C: Cat B: Cat A: Suite:

Enclosed please find a deposit in the amount of \$ _____ (\$600 per person) to secure reservations for _____ # of people.

Premier's Travel Protection Plan (TPP): Yes, I (we) wish to purchase travel protection (TPP)
(TPP must be purchased with initial deposit) No, I (we) decline travel protection (TPP)

Enclosed please find payment in the amount of \$ _____ (\$575 per person) to secure the Premier's Travel Protection Plan (TPP).

I/we want to purchase the Post London Extension*** (\$1199 pp dbl/+\$500 SS) Yes No

***Please book London Ext with initial deposit.

TOTAL PAYMENT \$ _____ Make checks payable to: PREMIER WORLD DISCOVERYDEPARTURE AIRPORT _____ ROOMMATE'S DEPARTURE AIRPORT _____
see flyer for included group departure airport/departure city, additional charges apply for other airport packages

To avoid change fees, submit Passport names (first/mid/last) exactly as they appear on Passports

Passport Name: _____DOB (MM/DD/YY) _____ Gender M F *No middle name on PP*

Passport #: _____ Exp Date (MM/DD/YY) _____

Country of Issuance _____

Street Address _____ Check if Roommate's address is the same

City _____ State _____ ZIP _____

Email address _____

Mobile # _____

Emergency Contact/Tel# _____

Notes: _____

Roommate's Passport Name: _____DOB (MM/DD/YY) _____ Gender M F *No middle name on PP*

Roommate's Passport #: _____ Exp Date (MM/DD/YY) _____

Country of Issuance _____



Cardholder Name (If paying by credit card) _____

Credit Card # _____ Exp Date: _____

CVV# _____ Amount to be charged \$ _____

Credit Card Billing Address: Check if address is the same as above

Address _____ City _____

State _____ ZIP _____ Tel# _____

Sign _____ Date _____

SIGNATURE REQUIRED (for credit card use & acceptance of terms*)

*I (We) agree to pay according to the credit card issuer agreement. I understand and accept the cancellation fees/policy and other terms.

DEPOSIT & FINAL PAYMENTAn Initial **Deposit of \$600 per person** is due with Reservation Form to secure reservations. Final Payment Due Date is 90 days prior to departure.***BOOKING DISCOUNT**

Make your Final Payment by check prior to the Final Payment Due Date

and receive **\$400 per couple/\$200 per person Booking Discount!****Cruise Only Packages receive \$200 per couple/\$100 per person BD.**

• Initial Deposit can be made by check or credit card to be eligible.

• Payments after Initial Deposit are part of Final Payment & must be made by check.

ONLINE BOOKING OPTION

Save time, postage & secure your seat for this group departure. Simply type:

https://res.premierworlddiscovery.com into your web browser & use the

Booking Number (Web Code) from this flyer to make your Deposit online in

just a few minutes. No need to submit a Reservation Form if booking online.

PREMIER'S TRAVEL PROTECTION PLAN (TPP) \$575 per person
(must purchase with Initial Deposit)**Part A – Cancellation Waiver provided by PWD****I. Trip Cancellation Waiver (TCW)** - Guarantees full refund on all payments, except the Trip Cancellation Waiver Fee itself in case of cancellation up to the time and date of departure due to the passenger's personal illness or death of an immediate family member. Medical/official documentation required.**II. Premier "Any Reason" Cancellation Waiver (ARCW)** - Reimburses 75%

of the cancellation fees in the form of a future travel credit certificate (FTCC)

valid for 1 year, if you cancel more than 48 hours prior to scheduled departure

for any reason not eligible for cash refund under the TCW (Part A - I). FTCC is non-transferable, may not be redeemed for cash and does not include

any credit for the Trip Cancellation Waiver Fee. **The Trip Cancellation****Waiver Fee must be paid for with Initial Deposit and is refundable until 180****days prior to departure. The Trip Cancellation Waiver does not cover any****single supplement charges due to an individual's traveling companion****canceled prior to departure.** The Trip Cancellation Waiver is non-transferable

and valid for each applicant only. The Trip Cancellation Waiver does not cover

any services such as airline tickets not purchased through PWD. Cancellations,

Refunds & Inquiries under Part A will be handled by PWD. Certain Ex-

clusions and Restrictions apply.

Part B – Post Departure Travel Protection Plan* provided by USI

Includes coverage for: Trip Interruption (\$1,000); Trip Delay (\$100/Day-Max

\$500); Baggage & Personal Effects (\$2,000); Baggage Delay (\$500); Emer-

gency Accident/Sickness Medical Expense-excess coverage (\$30,000); Emer-

gency Evacuation/Repatriation (\$150,000); Accidental Death & Dismember-

ment (\$25,000); Non-Insurance and Emergency Travel Assistance Services**

(\$24/7). Claims & Inquiries under Part B will be administered by USI.

For full Part A and Part B plan details visit: premierworlddiscovery.com/TPP

All Benefits described on this page are for general information basis only.

There are certain restrictions, exclusions and limitation that apply to all insur-

ance coverages. Plan benefits, limits and provisions may vary by state juris-

diction.

CANCELLATION FEES**Cancellations are subject to the following per person fees;**

- Cancel 180 days prior to departure: \$200 pp is retained
- Cancel 179-90 days prior to departure: Deposit or TPP** is retained
- Cancel 89-60 days prior to departure: 50% of total price
- Cancel 59-30 days prior to departure: 75% of total price
- Cancel 29 days or less prior to departure/no shows: No refunds

**If TPP purchased

RESPONSIBILITY

World Tours LLC dba Premier World Discovery ("PWD"), AFC Vacations ("AFC")

acts solely as an independent intermediary for travelers, using independent,

third-party suppliers to arrange for all travel services and products in connection

with your tour, including without limitation, transportation, accommodations,

cruises, activities, and other travel products and services. All such services are

provided by independent third-party suppliers and are not owned, managed,

or controlled by PWD. PWD and its affiliates, owners, employees, and

representatives assume no responsibility or liability for any act, omission, delay,

change in schedule, event, loss, damage, inconvenience, missed travel product/

service, or personal injury resulting from the actions, omissions or negligence

of you, or any supplier or third party, or for circumstances beyond PWD's direct

control. Your travel is also subject to the terms and conditions of suppliers (e.g.,

a contract for air transportation), which are between you and the suppliers.

PWD and/or its tour director reserves the right, in their sole discretion, for

any reason, to decline or require the withdrawal of any participant from a

tour or service. All claims or disputes related to travel services or these terms

must be resolved in California court under California law. Payment of deposit

constitutes acceptance of these conditions. CST #2163560-20

IMPORTANT CONDITIONS/NOTES:

A valid US passport is required for this tour and is the responsibility of each

passenger. Passports should be valid for at least six (6) months beyond the

travel dates. Itinerary & Hotels are subject to change.

AIR NOTE/SEAT REQUESTS/AIRLINE BAG FEES:

Air Schedules may not be available until Final Trip Documentation is received.

Airline baggage fees & seat assignment fees are not included in tour rates.

Many airlines do not provide advance seat assignments until check-in at the

airport. If specific seat requests or airline choice is extremely important to

your reservation, we recommend you book land only and make your own air

reservations. Please make this adjustment to land only/own air at time of tour

reservation.

